

# PARSELASYON PLANI

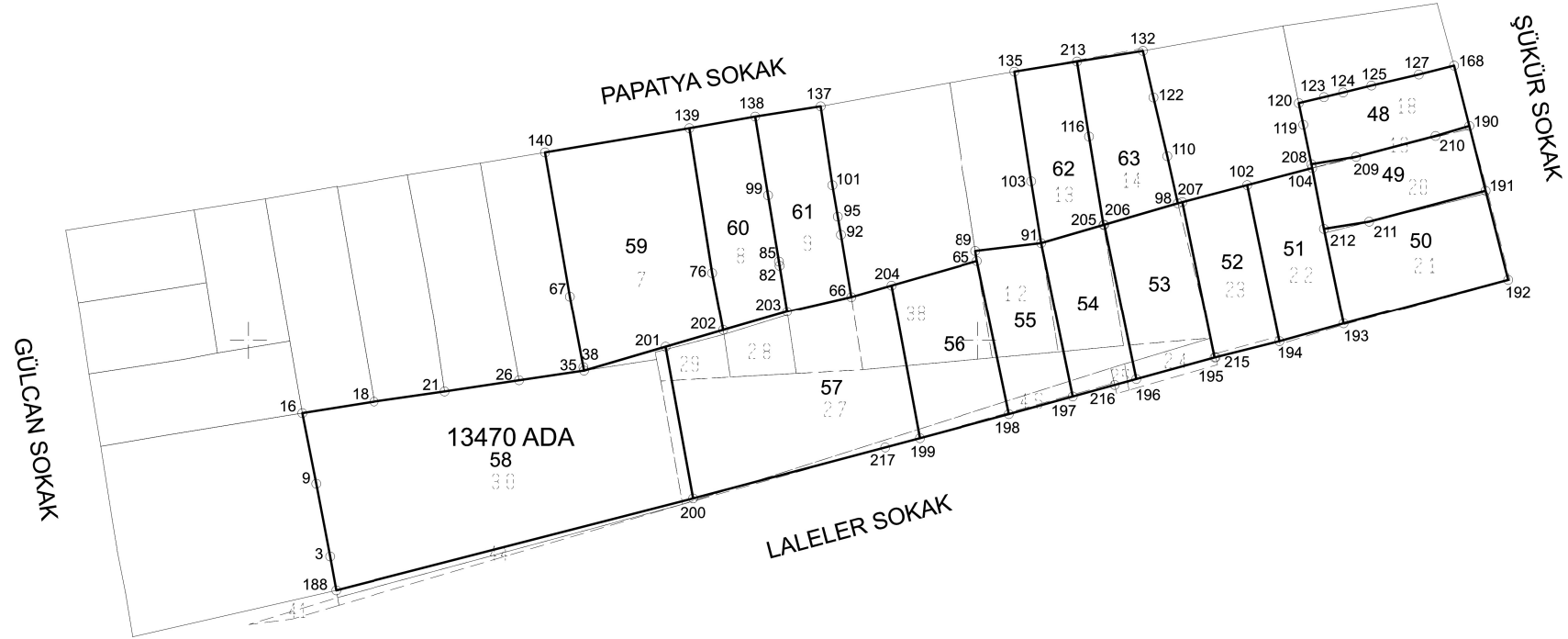

4404000  
5472000

Nokta No	Y	X	Nokta No	Y	X	Nokta No	Y	X
3	547011.18	4403970.46	9	547009.28	4403980.40	16	547007.37	4403990.06
18	547017.24	4403991.63	21	547026.95	4403993.02	26	547037.14	4403994.55
35	547046.03	4403995.87	38	547045.94	4403996.34	65	547099.88	4404010.98
66	547082.59	4404006.02	67	547044.99	4404006.09	76	547063.55	4404009.32
82	547072.78	4404010.32	85	547072.69	4404010.90	89	547099.86	4404012.35
91	547108.68	4404013.42	92	547081.17	4404014.55	95	547080.74	4404017.04
98	547127.38	4404018.86	99	547071.20	4404019.96	101	547080.00	4404021.34
102	547136.87	4404021.35	103	547107.31	4404021.87	104	547145.76	4404023.68
110	547125.94	4404025.31	116	547115.23	4404027.99	119	547144.54	4404029.60
120	547143.92	4404032.56	122	547124.05	4404033.33	123	547147.37	4404033.38
124	547149.99	4404034.01	125	547153.86	4404034.96	127	547160.35	4404036.47
132	547122.60	4404039.70	135	547105.02	4404036.86	137	547078.40	4404032.12
138	547069.44	4404030.72	139	547080.44	4404029.13	140	547040.69	4404025.82
168	547165.17	4404037.69	188	547012.02	4403965.83	190	547167.26	4404029.44
191	547169.48	4404020.58	192	547172.57	4404008.39	193	547150.06	4404002.34
194	547141.28	4403999.90	195	547132.41	4403997.66	196	547121.70	4403994.72
197	547113.01	4403992.33	198	547104.26	4403989.92	199	547091.99	4403986.63
200	547060.95	4403978.40	201	547057.18	4403999.14	202	547065.06	4404001.45
203	547073.81	4404003.99	204	547088.09	4404007.60	205	547117.21	4404015.90
206	547117.32	4404015.93	207	547128.00	4404019.02	208	547145.65	4404024.21
209	547151.76	4404025.22	210	547162.64	4404028.07	211	547153.55	4404016.35
212	547147.37	4404015.36	213	547113.59	4404038.24	215	547132.56	4403997.70
216	547118.75	4403993.91	217	547087.23	4403985.37			

4403900  
547000

4403900  
547100

— ada/blok sınırları  
- - - Uygulamaya tabi parsel sınırları

DÜZENLEYEN	UYGUNDUR BELEDİYE/ÖZEL İDARE	
	KONTROL EDEN	ONAYLAYAN
ADI SOYADI		
TARİH	4403900	5472000
İMZA		

TOPLAM ALAN : 5397,88  
TOPLAM PAY : 5397,88  
TOPLAM KAMULASTIRMA : 0,00  
TOP. DÜZENLE. GİRMEYEN : 0,00  
TOP. DÜZENLEMEYE GİREN : 5390,94

M A L S A H İ P L E R İ A R A Ş T I R M A  
V E  
Ö Z E T F O R M U  
( K A D A S T R O P A R S E L İ N E S İ R A L I )

SAYFA NO: 1

TOPLAM ADA ALANI : 5290,75  
OKATILIM ORANI : 0,0000000  
D.O.PAYI ORANI : 0,0193007

K A D A S T R O							I M A R					
SNo	Pafta	Ada/Par	Alan/Pay	Hisse	Matik/Baba Adı	Konu	Dop/İTh	Ada/Par	Alan	Hisse	Pay	
39	I25A-21-C-2-B	13470/7	591,32 591,32	TAM	KMC	-	11,41 579,91	13470/59	579,91	TAM	579,91	
41	I25A-21-C-2-B	13470/8	258,51 258,51	TAM	KMC	-	4,99 253,52	13470/60	253,52	TAM	253,52	
1	I25A-21-C-2-B	13470/9	324,60 162,30	1 2	AZİZ YALCINKAYA AHMET	-	31,3 1591,7	13470/57 13470/61	681,41 239,99	391,7/681,41 12000/23999	391,7 120,00	
46	I25A-21-C-2-B	13470/9	324,60 81,15	1 4	İSMAİL TOMSAK HAKKI	-	1,56 79,59	13470/57 13470/61	681,41 239,99	1959/681,41 6000/23999	1959 60,00	
47	I25A-21-C-2-B	13470/9	324,60 81,15	1 4	AYHAN TOMSAK HAKKI	-	1,57 79,58	13470/57 13470/61	681,41 239,99	1959/681,41 5999/23999	1959 59,99	
2	I25A-21-C-2-B	13470/12	136,34 136,34	TAM	EMİN EMRAH ERKME EYYUP	-	2,63 133,71	13470/55	201,77	13371/201,77	133,71	
3	I25A-21-C-2-B	13470/13	346,17 346,17	TAM	SUNA AYDIN EMİN	-	6,68 339,49	13470/54 13470/62	194,04 203,09	13640/19404 TAM	136,40 203,09	
4	I25A-21-C-2-B	13470/14	420,83 105,21	1 4	MUHTEREM SAHİNÖZ AHMET	-	2,03 1031,8	13470/53 13470/63	240,93 216,80	4898/240,93 5420/21680	48,98 54,20	
48	I25A-21-C-2-B	13470/14	420,83 315,62	3 4	İSMAİL SAHİNÖZ AHMET	-	6,09 309,53	13470/53 13470/63	240,93 216,80	14693/240,93 16260/21680	146,93 162,60	
5	I25A-22-D-1-A	13470/18	195,21 195,21	TAM	KMC	-	3,80 193,22	13470/48	193,22	TAM	193,22	
6	I25A-22-D-1-A	13470/19	31,9 31,9	TAM	ODUNPAZARI BELEDİYESİ	-		*****	DAĞ	GİRMEDİ	*****	
7	I25A-22-D-1-A	13470/20	204,61 204,61	TAM	ERDAL DUR MEHMET	-	3,95 200,66	13470/49	203,16	20066/203,16	200,66	
8	I25A-22-D-1-A	13470/21	292,97 292,97	TAM	KMC	-	5,76 292,34	13470/50	292,34	TAM	292,34	
9	I25A-22-D-1-A	13470/22	202,63 202,63	TAM	ERDAL DUR MEHMET	-	3,91 198,72	13470/51	198,72	TAM	198,72	
10	I25A-22-D-1-A	13470/23	199,93 199,93	TAM	KMC	-	0,00 199,93	13470/52	199,93	TAM	199,93	
11	I25A-21-C-2-C	13470/24	45,91 11,48	1 4	MUHTEREM SAHİNÖZ AHMET	-	0,22 11,26	13470/53	240,93	1126/240,93	11,26	
49	I25A-21-C-2-C	13470/24	45,91 34,43	3 4	İSMAİL SAHİNÖZ AHMET	-	0,67 33,76	13470/53	240,93	3376/240,93	33,76	

TOPLAM ALAN : 5397,88  
TOPLAM PAY : 5397,88  
TOPLAM KAMULASTIRMA : 0,00  
TOP. DÜZENLE. GİRMEYEN : 0,00  
TOP. DÜZENLEMESİNE GİREN : 5390,94

M A L S A H İ P L E R İ A R A S T I R M A  
V E  
Ö Z E T F O R M U  
( K A D A S T R O P A R S E L İ N E S İ R A L I )

SAYFA NO: 2

TOPLAM ADA ALANI : 5290,75  
OKATILIM ORANI : 0,0000000  
D.OPAYI ORANI : 0,0193007

K A D A S T R O

J M A R

SNo	Pafta	Ada/Par	Alan/Pay	Hisse	Malik/Baba Adı	Kamu	Dop/ITH	Ada/Par	Alan	Hisse	Pay
12	I25A-21-C-2-C	13470/25	6,68 6,68	TAM	ZAGUTOGLU INSAAT HAFRIYAT VE NAKLIYAT TICARET LTD. STI	-	0,13 6,55	13470/54	194,04	655/19404	6,55
52	I25A-21-C-2-C	13470/27	61,493 5,87	11 1152	GUNES ARGUN ALI HAYRETTIN	-	0,11 5,76	13470/57	681,41	576/68141	5,76
53	I25A-21-C-2-C	13470/27	61,493 5,87	11 1152	GULSEREN ARGUN ALI HAYRETTIN	-	0,11 5,76	13470/57	681,41	576/68141	5,76
54	I25A-21-C-2-C	13470/27	61,493 4,27	8 1152	ALI HAYRETTIN ARGUN ALI RIZA	-	0,08 4,19	13470/57	681,41	419/68141	4,19
55	I25A-21-C-2-C	13470/27	61,493 7,47	14 1152	VURAL ABDULLAH AKTULAY AHMET SALIM	-	0,14 7,33	13470/57	681,41	733/68141	7,33
56	I25A-21-C-2-C	13470/27	61,493 7,47	14 1152	ZEYNEP MERAL AKTULAY AHMET SALIM	-	0,14 7,33	13470/57	681,41	733/68141	7,33
57	I25A-21-C-2-C	13470/27	61,493 14,95	28 1152	GULSUM TASER KAZIM	-	0,28 14,67	13470/57	681,41	1467/68141	14,67
58	I25A-21-C-2-C	13470/27	61,493 4,98	7 864	GULER KOPRULU RECEP	-	0,09 4,89	13470/57	681,41	489/68141	4,89
59	I25A-21-C-2-C	13470/27	61,493 2,49	7 1728	GOKHAN KOPRULU UGUZ	-	0,04 2,45	13470/57	681,41	245/68141	2,45
60	I25A-21-C-2-C	13470/27	61,493 2,49	7 1728	ALPARSLAN KOPRULU UGUZ	-	0,05 2,44	13470/57	681,41	244/68141	2,44
61	I25A-21-C-2-C	13470/27	61,493 1,25	7 3456	RABIA ESIN KOPRULU MEHMET IHSAN	-	0,03 1,22	13470/57	681,41	122/68141	1,22
62	I25A-21-C-2-C	13470/27	61,493 3,74	7 1152	NILGUN NIMET DELIBAS GURBUZ	-	0,08 3,66	13470/57	681,41	366/68141	3,66
63	I25A-21-C-2-C	13470/27	61,493 153,73	1 4	SUNA AYDIN EMIN	-	2,97 150,76	13470/57	681,41	15076/68141	150,76
13	I25A-21-C-2-C	13470/27	61,493 126,51	79 384	KALENDER YASASIN MUSTAFA	-	2,45 124,06	13470/57	681,41	12406/68141	124,06
50	I25A-21-C-2-C	13470/27	61,493 21,939	274 768	TOLGA OZKILIC HATEM	-	4,24 21,515	13470/57	681,41	21515/68141	21,515
51	I25A-21-C-2-C	13470/27	61,493 54,45	17 192	AZIZ YALCINKAYA AHMET	-	1,06 53,39	13470/57	681,41	5339/68141	53,39
14	I25A-21-C-2-C	13470/28	63,15	TAM	ODUNPAZARI BELEDIYESI	-	1,22	13470/49	203,16	250/20316	2,50

TOPLAM ALAN : 5397,88  
TOPLAM PAY : 5397,88  
TOPLAM KAMULASTIRMA : 0,00  
TOP. DÜZENLE. GİRMEYEN : 0,00  
TOP. DÜZENLEMeye GİREN : 5390,94

MAL SAHİPLERİ ARASTIRMA  
VE  
ÖZET FORMU  
( KADASTRO PARSELINE SIRALI )

SAYFA NO: 3

TOPLAM ADA ALANI : 5290,75  
OKATILIM ORANI : 0,0000000  
D.O.PAYI ORANI : 0,0193007

K A D A S T R O

J M A R

SNo	Pafta	Ada/Par	Alan/Pay	Hisse	Malik/Baba Adı	Konu	Dop/ITH	Ada/Par	Alan	Hisse	Pay
			6315				61,93	13470/56	266,53	5943/26653	59,43
15	I25A-21-C-2-B	13470/29	47,50 47,50	TAM	ODUNPAZARI BELEDİYESİ		0,92 46,58	13470/54 13470/55	194,04 201,77	4130/19404 528/20177	41,30 5,28
16	I25A-21-C-2-C	13470/30	1121,21 1121,21	TAM	DÜNYA GIDA LTD STJ MUSTAFA		21,63 1099,58	13470/58	1125,39	109958/112539	1099,58
17	I25A-21-C-2-B	13470/38	211,18 211,18	TAM	ODUNPAZARI BELEDİYESİ		4,08 207,10	13470/56	266,53	20710/26653	207,10
64	I25A-21-C-2-C	13470/41	9,98 1,99	1 5	İBRAHİM DOĞAN CİRİK MUSTAFA		0,03 1,96	13470/54	194,04	196/19404	1,96
65	I25A-21-C-2-C	13470/41	9,98 2,00	1 5	İLHAN CİRİK MUSTAFA		0,03 1,97	13470/54	194,04	197/19404	1,97
66	I25A-21-C-2-C	13470/41	9,98 2,00	1 5	LALE TÜMTÜRK MUSTAFA		0,04 1,96	13470/54	194,04	196/19404	1,96
67	I25A-21-C-2-C	13470/41	9,98 2,00	1 5	ZEYNEP ERSÖZLÜ MUSTAFA		0,04 1,96	13470/54	194,04	196/19404	1,96
68	I25A-21-C-2-C	13470/41	9,98 0,87	7 80	ESMA SOLMAZ CİRİK HÜSEYİN		0,02 0,85	13470/54	194,04	85/19404	0,85
69	I25A-21-C-2-C	13470/41	9,98 1,12	9 80	MUSTAFA CİRİK İBRAHİM KEMAL		0,03 1,09	13470/54	194,04	109/19404	1,09
19	I25A-21-C-2-C	13470/44	26,32 26,32	TAM	DÜNYA GIDA LTD STJ MUSTAFA		0,51 25,81	13470/58	1125,39	2581/112539	25,81
70	I25A-21-C-2-C	13470/45	64,02 12,81	1 5	İLHAN CİRİK MUSTAFA		0,25 12,56	13470/55	201,77	1256/20177	12,56
44	I25A-21-C-2-C	13470/45	64,02 12,81	1 5	İBRAHİM DOĞAN CİRİK MUSTAFA		0,25 12,56	13470/55	201,77	1256/20177	12,56
71	I25A-21-C-2-C	13470/45	64,02 12,80	1 5	LALE TÜMTÜRK MUSTAFA		0,25 12,55	13470/55	201,77	1255/20177	12,55
72	I25A-21-C-2-C	13470/45	64,02 12,80	1 5	ZEYNEP ERSÖZLÜ MUSTAFA		0,25 12,55	13470/55	201,77	1255/20177	12,55
73	I25A-21-C-2-C	13470/45	64,02 5,60	7 80	ESMA SOLMAZ CİRİK HÜSEYİN		0,11 5,49	13470/55	201,77	549/20177	5,49
74	I25A-21-C-2-C	13470/45	64,02 7,20	9 80	MUSTAFA CİRİK İBRAHİM KEMAL		0,13 7,07	13470/55	201,77	707/20177	7,07

TOPLAM ALAN : 5397.88  
TOPLAM PAY : 5397.88  
TOPLAM KAMULASTIRMA : 0.00  
TOP. DÜZENLE. GİRMEYEN : 0.00  
TOP. DÜZENLEMEYE GİREN : 5390.94

MAL SAHİPLERİ ARAŞTIRMA  
VE  
ÖZET FORMU  
( KADASTRO PARSELINE SIRALI )

SAYFA NO: 4

TOPLAM ADA ALANI : 5290.75  
OKATILIM ORANI : 0.0000000  
D.OPAYI ORANI : 0.0193007

K A D A S T R O							I M A R				
SNo	Pafta	Ada/Par	Alan/Pay	Hisse	Malik/Baba Adı	Kamu	Dop/İth	Ada/Par	Alan	Hisse	Pay
21	I25A-22-D-1-A	13470/46	5.16 5.16	TAM	ODUNPAZARI BELEDİYESİ	-		*****	DAG.	GİRME DI	*****
45	I25A-21-C-2-C	13470/47	5.53 5.53	TAM	ODUNPAZARI BELEDİYESİ	-		*****	DAG.	GİRME DI	*****